

# FLAT FITTINGS RFF

## Flat joiners for seamless channel alignment

RFF flat fittings bring two channels into a flush joint by maintaining alignment and continuity in modular support constructions.

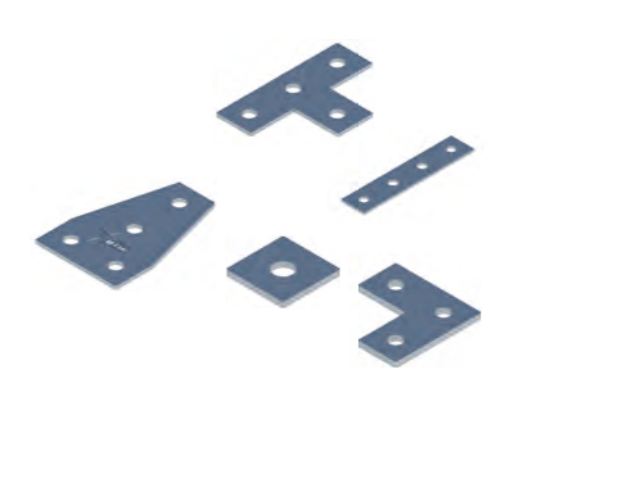

### Material

- Steel Grade-E250
- Coating- Electrogalvanized, Hot Dip Galvanized

### Key Features & Benefits

- Pre-punched design allows quick bolting to channels without drilling.
- Compatible with multiple channel profiles and support accessories.
- Provides rigid joints without the need for welding.
- Corrosion protection by Electrogalvanized, Hot Dip Galvanized finishes.

### Application

- Designed as a connecting element for joining channels in framing and support systems.

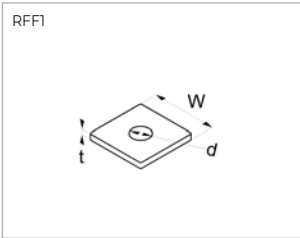
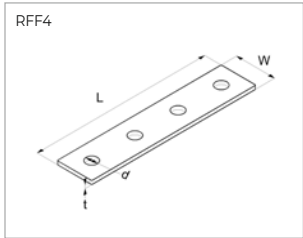
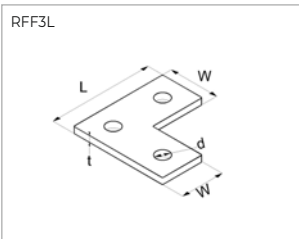
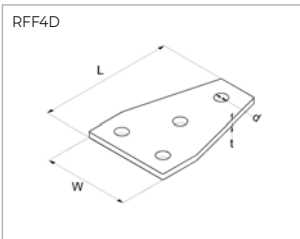
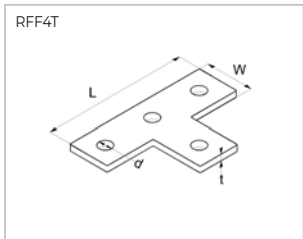

W	Width
L	Length
t	Thickness
d	diameter



Product Variants

Item No.	Description	Hole Size (mm)	Sales Unit (Pcs)
403501	Flat fitting RFF 1 GI	13	25
403502	Flat fitting RFF 4 GI	13	25
403503	Flat fitting RFF 4D GI	13	25
403504	Flat fitting RFF 3L GI	13	25
403505	Flat fitting RFF 4T GI	13	25
403507	Flat fitting RFF 1 HDG	13	25
403508	Flat fitting RFF 4 HDG	13	25
403509	Flat fitting RFF 4D HDG	13	25
403510	Flat fitting RFF 3L HDG	13	25
403511	Flat fitting RFF 4T HDG	13	25

**RISE DBS Private Limited**

Bannerghatta Road, Bangalore,  
Bangalore South, Karnataka,  
India, 560076



**Contact us**

**[info@rise-dbs.com](mailto:info@rise-dbs.com) | [www.rise-dbs.com](http://www.rise-dbs.com)**