

PROFILE WING NUT RPN

Easy-tighten nut for secure and fast installs.

RPN wing nut is designed for torque-tightening of channel connections. Reduces installation time while maintaining strong joint reliability.



Application

- Designed for secure connection between channels and accessories using bolts.



Material

- Steel Grade-S235
- Coating- Electrogalvanized, Hot Dip Galvanized

Key Features & Benefits

- Ergonomic plastic wing allows easy hand tightening, reducing tool use and speeding up installation.
- Provides a comfortable grip and prevents injuries from sharp metal edges.
- Lightweight yet robust design ensures safe and reliable load transfer.
- Corrosion-protected surfaces and durable plastic components extend service life.
- Versatile range (M8-M16) offers flexibility for multiple project applications.

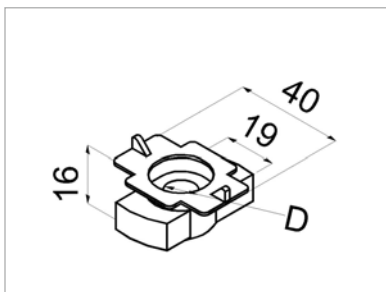



PROFILE WING NUT RPN

Product Variants

| Item No. | Description | Dia D (mm) | Tightening Torque (Nm) | Sales Unit (Pcs) |
|----------|-----------------------------|------------|------------------------|------------------|
| 402801 | Profile wing nut RPN 8 GI | M8 | 20 | 100 |
| 402802 | Profile wing nut RPN 10 GI | M10 | 40 | 100 |
| 402803 | Profile wing nut RPN 12 GI | M12 | 50 | 100 |
| 402804 | Profile wing nut RPN 16 GI | M16 | 50 | 100 |
| 402809 | Profile wing nut RPN 8 HDG | M8 | 20 | 100 |
| 402810 | Profile wing nut RPN 10 HDG | M10 | 40 | 100 |
| 402811 | Profile wing nut RPN 12 HDG | M12 | 50 | 100 |
| 402812 | Profile wing nut RPN 16 HDG | M16 | 50 | 100 |

RISE DBS Private Limited

Bannerghatta Road, Bangalore,
Bangalore South, Karnataka,
India, 560076



Contact us

info@rise-dbs.com | www.rise-dbs.com