

# PURLIN CLAMP RPC

## Quick-fit clamp for roof purlin fixings

RPC purlin clamp allows fast, drill-free attachment for Z-purlins. Suitable for hanging HVAC, sprinkler, or cable tray systems from metal roofs.



## Application

- Designed for suspending threaded rods directly from purlins without drilling or welding.
- Provides a secure connection to purlins for lightweight and medium-duty support systems.



## Material

- Steel Grade-E250
- Coating Electrogalvanized, Hot Dip Galvanized

## Key Features & Benefits

- Fast and simple installation by clamping directly to purlins, eliminating the need for drilling holes.
- No damage to structure and preserves purlin strength.

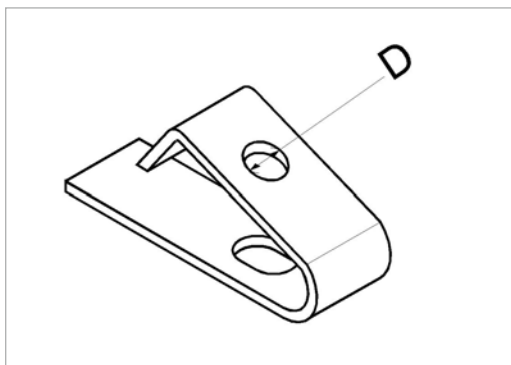

D	Hole Diameter
---	---------------



PURLIN CLAMP RPC

Product Variants

Item No.	Description	Strip Thickness t (mm)	Hole Size D (mm)	Torque (Nm)	Load (kN)	Sales Unit (Pcs)
401755	Purlin Clamp RPC	2	13	10	1.0	50

**RISE DBS Private Limited**

Bannerghatta Road, Bangalore,  
Bangalore South, Karnataka,  
India, 560076



**Contact us**

**[info@rise-dbs.com](mailto:info@rise-dbs.com) | [www.rise-dbs.com](http://www.rise-dbs.com)**